

TM9-2320-209-20P

Current part is item (7) on diagram. Available at www.oshkoshequipment.com

(1) (a) FIG. NO.	(2) (b) ITEM NO.	(3) SMR CODE	(3) NATIONAL STOCK NUMBER	(4) PART NUMBER	(5) FSCM	(6) DESCRIPTION USABLE ON CODE	(7) U/M	(8) INC IN UNIT
1407-MECHANICAL STEERING GEAR ASSEMBLY (CONT'D)								
137	5	PAOZZ	5310-00-763-8905	MS51968-20	96906	NUT, PLAIN, HEXAGON: TIE ROD CLAMP	EA	4
137	6	PAOZZ	4730-00-050-4208	MS15003-1	96906	FITTING, LUBRICATION: TIE ROD END	EA	2
137	7	PAOZZ	2530-00-752-1601	7521602	19207	TIE ROD END, STEERING: LEFT, W/ STUDS (COMPONENTS SAME AS END ASSEMBLY, NSN 2530-00-752-1601, EXCEPT WHERE INDIVIDUAL COMPONENTS ARE ANNOTATED)	EA	1
137	7	PAOZZ	2530-00-752-1602	7521601	19207	END ASSEMBLY: RIGHT, W/ STUDS	EA	1
137	8	PAOZZ	5310-00-835-2140	MS35693-69	96906	NUT, SLOTTED, HEXAGON: END STUD	EA	2
137	9	PAOZZ	2530-00-752-1606	7521606	19207	BOOT, DUST AND MOISTURE: END STUD	EA	2
137	10	XAOZZ		7699788	19207	PLUG	EA	2
137	11	XAOZZ		11621680	19207	SPRING, STEERING TIE: TIE ROD END STUD SEAT	EA	2
137	12	XAOZZ		11621578	19207	SEAT	EA	1
137	13	XAOZZ		11621582	19207	STUD	EA	1
137	14	XBOZZ		11621577	19207	BEARING	EA	1
137	15	XAOZZ		11621579	19207	END: RIGHT (USED ON END ASSEMBLY, NSN 2530-00-752-1601, ONLY)	EA	1
137	15	XAOZZ		11621581	19207	END: LEFT (USED ON TIE ROD END, NSN 2530-00-752-1602, ONLY)	EA	1
137	16	PAOZZ	2530-00-752-1608	7521608	19207	CLAMP	EA	4
137	17	XBOZZ		8757689	19207	TIE ROD	EA	1
138	1	PAOZZ	5310-00-995-1833	7748769	19207	NUT, PLAIN, HEXAGON	EA	1
138	2	PAOZZ	2530-00-277-2689	7521474	19207	STEERING WHEEL	EA	1
138	3	PAOZZ	5330-00-832-7140	8327140	19207	PACKING WITH RETAINER	EA	1

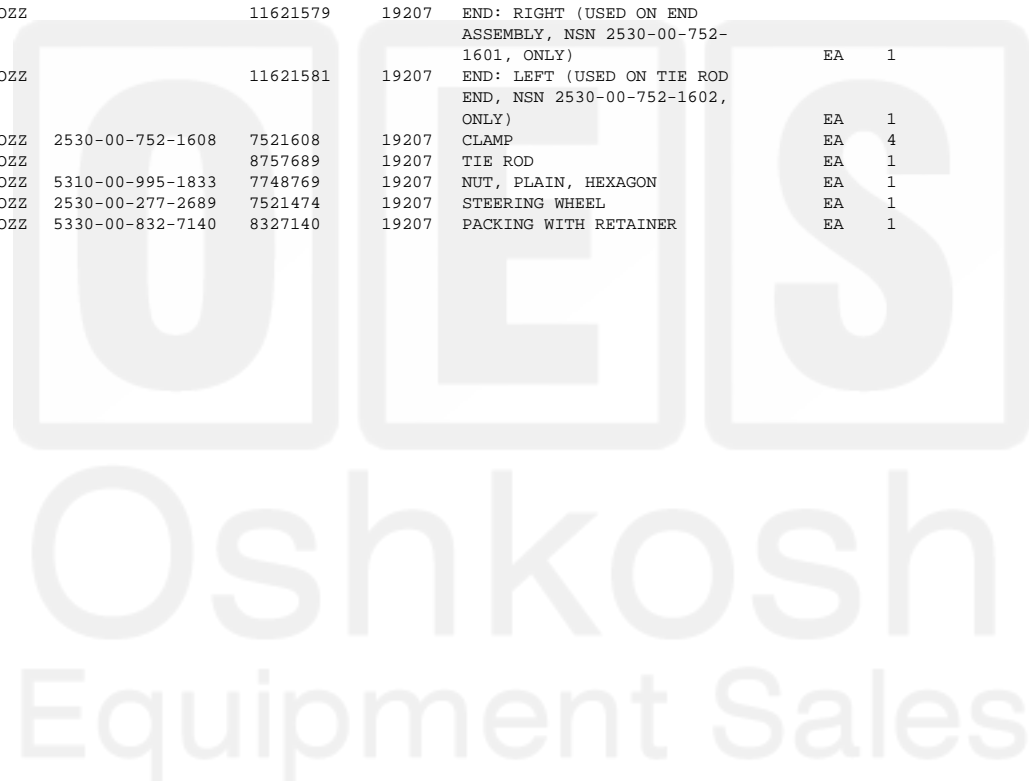

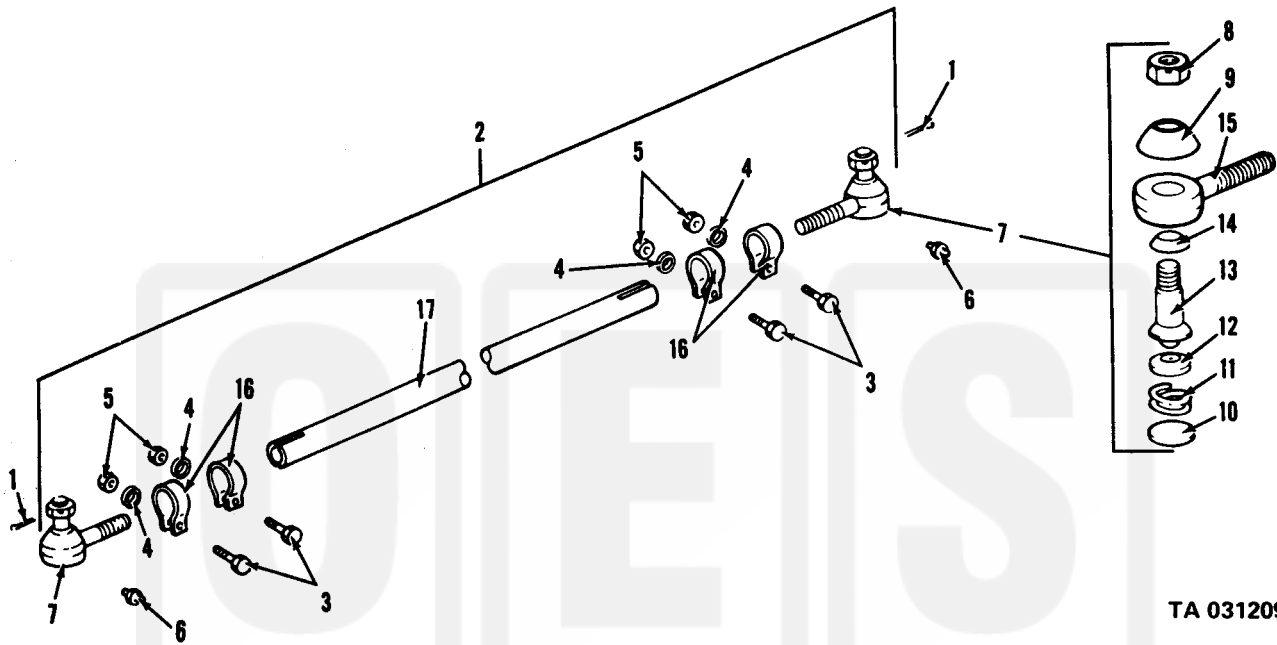

TA 031209

Figure 137. Tie rod steering assembly.

Oshkosh
Equipment Sales